

Chassis Components - General Equipment

Winding Handles

Amended 14.04.10

Winding handles manufactured in either solid round bar or ERW tube and supplied with a 't' slotted end or pressed hexagon ends

All handles finished in zinc and yellow passivate to BS1706 and supplied with a rotating double width steel hand grip finished in EPD black

Hexagon adaptors can be used to convert from round drive shafts for use with hexagon handles

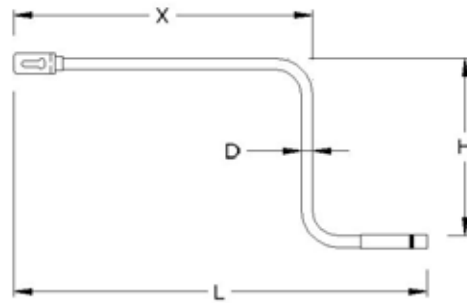

Product Reference	Type	L	H	D	X	Mass Kgs
V81332	ERW Tube	790	350	32	530	2.6
V81028	BDMS Bar	840	350	22	560	4.0
V81029	BDMS Bar	820	350	22	540	3.5

Hexagon Extensions

Hexagon drive extensions machined from solid hex bar

Supplied Finish: Zinc and yellow

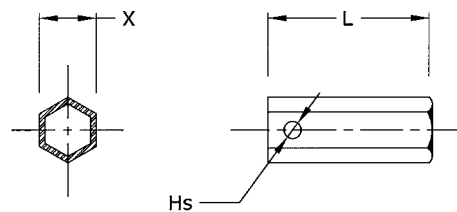

Product	X	L	Hs
V81040	32	102	11

Phone: 01474 321954 Fax 01474 321988